



D R E A M S E E K E R

F-14

DREAMSEEKERCARAVANS.COM.AU



BUILT TO IMPRESS

Dreamseeker Caravans F14 Tomcat is set to cause a stir with its high impact design, endless features and overall appearance. This is a Toy Hauler engineered and designed with a difference.



ENTERTAINMENT, EXHILARATION AND EXCITEMENT

After a day of riding you will look forward to returning to an environment like no other. The two-zone living space makes the Tomcat one of the smartest designs on the market. A classy Dometic quad lock door separates the two areas. To the front of the van we have the main living and sleeping areas. An east to west bed gives additional space and comfort. The interior design is very attractive with inclusions such as premium tapware, leather upholstery, matt black handles and a visually stunning bench top with a sleek stone feel.

Zone two is where things get really interesting. It is hard to miss the presence of a 49" Sony 4K Ultra HD Smart TV mounted efficiently along the side-wall with a Sony 6.2" Touchscreen DVD/Media player, Sony Amplifier and Sony Speakers. As if this wasn't impressive enough, fitted into the entertainment unit you will also find a Sony Playstation 4 Bundle Pack. You would be forgiven for thinking you were no longer inside a Toy Hauler.

Apart from its visual appeal Dreamseeker have also made sure that the F14 Tomcat is practical. They have included a full oven, reverse cycle Air Con, 185ltr Dometic 3-way fridge and a 4kg front loader washing machine.

The F14 Tomcat also includes RGB strip lighting. Customers can match their LED lighting to their favorite colour or the colours of a particular racing team all with the click of a button. Genius!

The Tomcat is loaded with features that make this model a camping enthusiasts dream van. A 32" smart TV is built into a customized unit in the main bedroom area. This is further complimented with state of the art speakers, WIFI, and a CD/DVD player.

Dreamseeker have designed and produced a very smart van with the F14 Tomcat. To power up this beast they have included a full Redarc battery management system, an inverter, 2 x 150 watt solar panels and 2 x 120 amp AGM batteries. All that's left to do is hook up and get on the road.



SLICK, SOPHISTICATED, JAW DROPPING

It is undeniable that the F14 Tomcat offers customers something new, exciting and impressive. Internally it is certainly made for entertaining. It is equally as impressive on the outside. For strength and durability Dreamseeker designed this model with its intended purpose very much at the forefront of their minds.

The chassis is 6" throughout. The ever-reliable and extensively tested Tuff Ride suspension offers an impressive ATM of 4T. A set of All Terrain Tyres come as standard with one spare cleverly mounted underneath the van. The frame is Aluminum throughout adding additional strength to F14.

The bold, dominating black Aluminum Composite exterior undoubtedly captures attention. The stylish Dreamseeker logo and branding really stand out and make the Tomcat a visually stunning van on the road.

For comfort and safety there is an electric step, reverse camera and five external LED lights as well as additional bar lights. Dreamseeker have ensured they include plenty of external lighting for moving bikes and other items in and out of the van as required.



FREEDOM AT YOUR FINGERTIPS

The Dreamseeker F14 Tomcat offers customers an opportunity to experience the freedom of what we all know to be the ultimate outdoor lifestyle. Packed with features and crafted out of passion, the F14 Tomcat captures the raw, exhilarating and adventurous side of caravanning with a rare and beautiful twist.

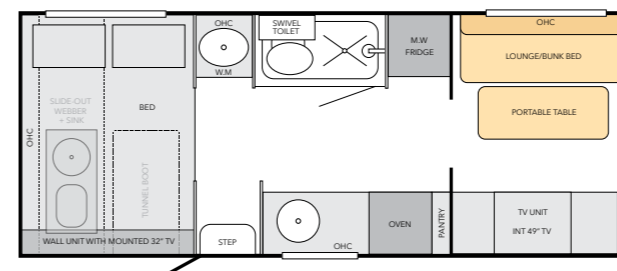
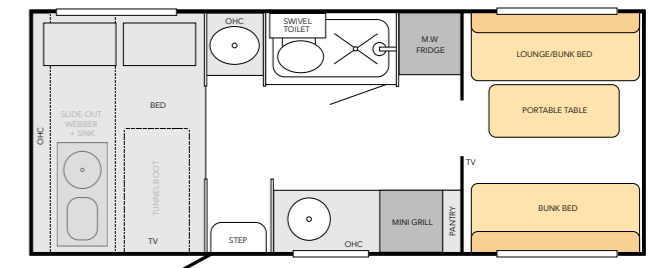
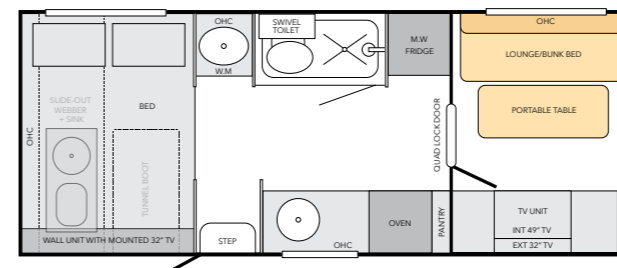

TECH SPECS

Body Length	21FT
Tare (Approx)	TBC
Ball (Approx)	TBC
Chassis	6" Dura Gal
Suspension	4t Tuff Ride
Warranty	12 Month Warranty

SPECIFICATIONS - F-14 MODELS

- STANDARD INCLUSION
- OPTIONAL INCLUSION
- N/A NOT APPLICABLE

	21T -F-14 TOMCAT \$120K +ORC	21T -F-14 XT \$100K +ORC	21T -F-14 \$80K +ORC
INTERIOR			
Flooring - Complite Honey Comb with Vinyl	●	●	●
Bed - East to West (1500 x 2225)	●	●	●
Bed - 1 x Bunk	●	●	○
Bed - 2 x Bunk	○	○	●
Bed - 4 x Bunk	○	○	○
Mattress - Nikpol Innerspring with Pillow-top	●	●	●
Door - Quad Lock Door b/w & Toy Zone	●	○	○
Table - Darche TRAKA 1200 Portable Table	●	●	●
Windows - Double-Glazed	●	●	●
Door - Quad Lock with sep Security Screen (Matt Black)	●	○	N/A
Door - Quad Lock with sep Security Screen (White)	N/A	○	●
Drawers - On Rollers	●	●	●
Floor Vinyl - Durable Modern Design	●	●	●
Floor Rubber - Toy Area & Tail Gate	●	○	○
Hatch Roof - 2 x 700mm x 500mm	●	●	●
Hatch - Pressure	○	○	○
Shower	●	●	●
Toilet	●	●	●
Basin - Ceramic (Ensuite)	●	●	●
Water Filter	●	●	●
Tapware - Premium Matt Black (Kitchen & Bathroom)	●	●	○
Sink - Undermount Single Bowl Stainless Steel	●	○	○
Sink - Overmount Single Bowl Stainless Steel	N/A	●	●
Bench Top - HiMacs Acrylic (Stone Feel)	●	○	○
Bench Top - Rolled Laminate	N/A	●	●
Handles - Matt Black	●	●	●
Hinges - Indaux Delta Lifting System	●	●	●
Cupboard Doors - Premium Gloss or Matt	●	●	●
Mirrors - Vanity Doors	●	●	●
Splashback Kitchen - Acrylic Full Height	●	●	●
TV - Bracket	3	3	2
Upholstery - Leather	●	●	○
Upholstery - Faux Vinyl Leather	N/A	N/A	●

APPLIANCES			
Air Conditioning - Dometic Harrier Inverter	●	●	●
Oven - 3 Gas / 1 Electric Burner & Grill	●	●	○
Mini Grill - 3 Gas / 1 Electric Burner & Grill	○	○	●
Range Hood - 12v LED with Twin Fans	●	●	●
Hot Water Service - 22.6ltr Gas/Electric	●	●	●
Fridge/Freezer - 185Ltr Dometic 3-Way Absorbtion	●	●	●
Microwave - 25Ltr	●	●	●
Washing Machine - 4kg Front Loading	●	●	○
ELECTRICAL (INTERIOR)			
Lighting - LED Down Lights	●	●	●
Strip Lighting - RGB (Customisable Colours)	●	○	○
Strip Lighting - Blue	N/A	●	●
Stereo CD/DVD/MP3/Radio System (Furion)	N/A	N/A	●
Media Player - Sony 6.2" Touchscreen DVD/Media Player with Bluetooth	●	●	○
TV - Sony 49" X7000E 4K Ultra HD LED LCD Smart TV	●	●	○
TV - 32" Smart LED / LCD (Connects to Wifi)	●	○	○
TV - 24" Smart LED / LCD (Connects to Wifi)	○	●	●
TV - Co-Ax Point	3	3	2
TV - Aerial Point	3	3	2
Wifi	●	●	○
Satalite - Satking Pro Max Fully Automatic Motorised Satellite TV System	●	○	○
Inverter - Redarc 3000 Watt	●	●	○
Battery Charger - Redarc Manager 30 Battery Management System	●	●	○
Battery Charger - BMPRO 35 with Trek Digital Display	N/A	N/A	●
Speakers - 2 x External (Furion)	●	●	●
Speakers - 2 x Sony 6½" 3-Way Speakers	●	●	○
Speakers - 2 x Sony 6 x 9" 3-Way Speakers	●	●	○
Amplifier - Sony 4 Channel	●	●	○
Sony Playstation 4 Bundle Pack	●	●	○
Switches - Acrylic Black & Silver	●	●	○
Switches - White	N/A	N/A	●

- STANDARD INCLUSION
- OPTIONAL INCLUSION
- N/A NOT APPLICABLE

	21T -F-14 TOMCAT \$120K +ORC	21T -F-14 XT \$100K +ORC	21T -F-14 \$80K +ORC
EXTERIOR			
Flooring - Complite Honey Comb with Vinyl	●	●	●
Awning - Roll-Out (Charcoal)	●	●	●
Gas Bayonet	●	●	●
Picnic Table - Fold-Out	●	●	●
Gas Bottles - 2 x 9kg (Housed in Toolbox)	●	●	●
Jack - Cnr Supports (Drop Down)	●	●	●
Jockey Wheel - A-Frame	●	●	●
Shower - External	●	●	●
Tap - On A-frame	●	●	●
Water Tanks - 2 x 95Ltr	●	●	●
Water Tanks - 95Ltr (Grey)	●	○	○
Wheels - 16" Alloy	●	●	●
Tyres - All Terrain	●	●	●
Spare Wheel - 1 x Underslung	●	●	●
Jerry Can holders - 2 x 20Ltr (Toolbox)	●	●	○
Storage Mesh Plate - A-Frame	●	●	○
Storage Mesh Plate - with PVC Mat	●	○	○
Tunnel Boot - Slide-Out Webber Q or BBQ & Sink	●	●	●
Boot - with 12vlt Drawer Fridge	●	○	○
Tool Box - with Slide-Out Generator Bracket (Front)	●	●	●
Hitch - D045	●	○	○
Hitch - D035	N/A	●	●
Grab Handles - Door, Front & Back (Matt Black)	●	●	●
ELECTRICAL (EXTERIOR)			
Light - 3 x Bar (Front & Back)	●	●	○
Light - 5 x LED	●	●	●
USB - 2 x Points	●	●	●
Power - 12V Weather Proof Cig Socket	●	●	●
Power - 240V Weather Proof Outlet (Single)	●	●	●
Antenna - Dometic (Reads Horizontal & Vertica Signals)	●	●	●
Plug Car - 12 Pin	●	●	●
Solar System - 2 x 150 watt Panels & Regulator	●	●	●
Battery - 2 x 120amp AGM	●	●	●
Step - Single (Electric)	●	●	●
Reverse Camera with Display	●	●	○

Hatch - Entertainment with Mounted 32" Smart LED / LCD TV (Connects to Wifi)	●	○	○
Hatch - Entertainment (Bracket & Points Only)	N/A	●	●
Brakes - Electric Breakaway System	●	●	●
PROTECTION			
Stone Protection - Undercarriage Checkerplate (Plumbing)	●	○	○
Stone Guard - Mesh (A-Frame)	●	○	○
Checker Plate Front 600mm (Steel Pearl)	●	●	●
Checker Plate Sides 600mm (Steel Pearl)	●	●	●
Checker Plate Back 600mm (Steel Pearl)	●	●	●
Mudflaps - Stone Guard Mesh (Front)	●	○	○
Mudflaps - Back (Dreamseeker)	●	●	●
SUSPENSION			
4t Tuff Ride	●	○	○
3.5t Tuff Ride	N/A	●	●
CONSTRUCTION			
A-Frame 6"	●	●	●
Axle - Double	●	●	●
Chassis - 6" Dura Gal	●	●	●
Frame - Aluminium	●	●	●
Cladding - Ali-Comp (Matt Black)	●	○	○
Cladding - Ali-Comp (White)	○	●	●
Insulation - Walls & Roof	●	●	●
Flooring - Complie			



D R E A M S E E K E R

DREAMSEEKERCARAVANS.COM.AU

COPYRIGHT © 2017 DREAMSEEKER CARAVANS
ALL SPECIFICATIONS & PRICES ARE SUBJECT TO CHANGE AT ANY TIME.
IMAGES ARE FOR ILLUSTRATION PURPOSES ONLY.